

**Acoustic Window**

**Noise Control**  $R_{w,P}$  **44 dB** in accordance with DIN EN ISO 10140-2

\* **Glazing Type**                      **Anti-vandal**      **P4A up to P7B**  
    **Bullet proof**      **BR1 up to BR7**

**Range of Dimensions:**              **Width from 400 mm to 4000 mm**  
    **Height from 400 mm to 2000 mm**

(\* special options )

**Technical specification and text for invitation to tender**

**Product:**                                      **SFB acoustic window brand Buchele in accordance with  
 DIN EN ISO 10140-2**

**Window Type:**                              **SFB 44**

**Noise control  $R_{w,P}$**                               **44 dB**

**Dimension:**                                      **.... x .... mm**

**Frame:**                                      Four-sided circumferential folded single part closed frame adjusted to  
 thickness of wall with glazing bars clipped in on both sides.  
 Without edge damping, therefore smooth vision area between the glazing  
 coated matte black.  
 On request the vision area between the glazing may be coated in various  
 RAL colours.

**Glazing:**                                      Two acoustical separated vertical mounted single glass sheets made of  
 safety glass fixed in two-sided sponge rubber in the frame.

**Surface:**                                      Frame and glass bars galvanized and primed with one component Primer  
 similar RAL 7001.

**Mounting:**                                      Delivery and professional assembly including filling of the cavities in the  
 frame with mortar of group III.

**Special Models**

**Glazing Types:**                              Anti-vandal P4A up to P7B safety glazing

    Bullet proof BR1 up to BR7 safety glazing

    Installation of anti-reflective glazing

**Edge Damping:**                              Complete edge damping individually adapted to the wall thickness made of  
 matte black coated perforated metal sheet with mineral fibre lining.  
 The edge damping is invisible attached to the frame so that no  
 disturbing elements will interfere with the even optic of the edge damping.  
 On request the edge damping may be coated in various RAL colours.

**Note:**  
 (Edge damping is not required to obtain the acoustic value  $R_{w,P}$  44 dB)

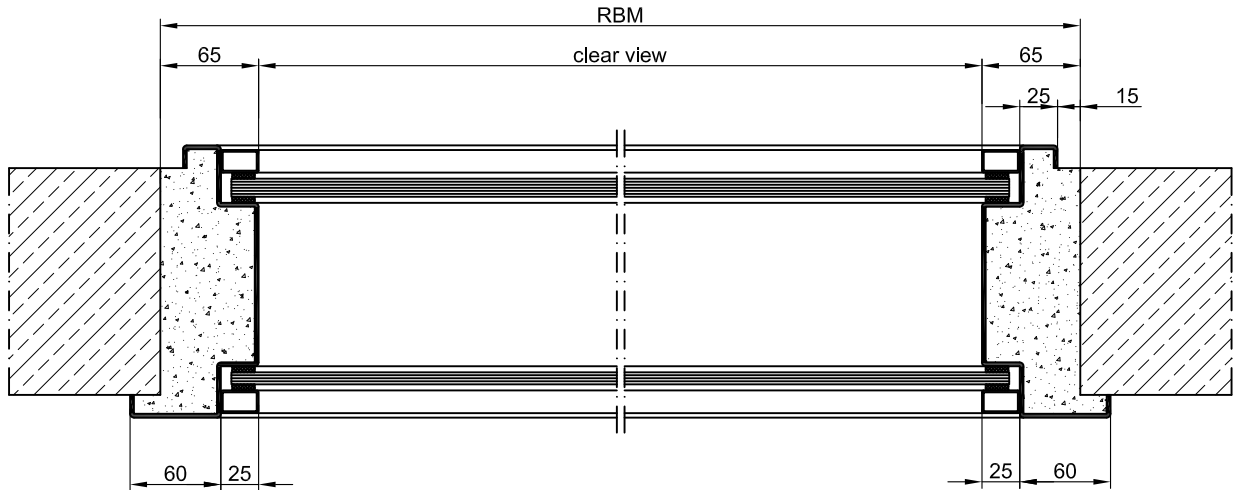

Encasing frame

Block frame

Encasing frame (2-parts)

