

Multi Wing Burglar Proof Folding Door

Burglar Proof	RC4	in accordance with DIN EN 1627
Noise Control	R_{w,P} 50 dB	in accordance with DIN EN ISO 10140-2
Air Tight	Class 4	in accordance with DIN EN 12427
Rain and Fire Water Tight	Class 3	in accordance with DIN EN 12489
Wind Tight	Class 4	in accordance with DIN EN 12444

* Shot Inhibiting	FB4	in accordance with DIN EN 1522
* Pressure resistant	up to 5 kPa	in accordance with DIN EN 13124-1
* Glazing		
* Pedestrian door		
* Stainless steel		

Range of Dimensions: **Width from 2500 mm to 5000 mm**
Height from 1750 mm to 5000 mm

(* special options see back of page)

Technical specification and text for invitation to tender

Product:	FT-SEC multi wing burglar proof folding steel door brand Buchele in accordance with DIN EN 1627
Door Type:	FT-SEC RC 4
Burglar Proof:	RC 4
No. of wings:	3 to 8 wings
Dimensions: x mm
Door Leaf:	Double walled, level 95 mm thick steel door leaf without hinge embossing, three sides folded with thick rebate and adjustable fixed sealing profile in the fold. Without bottom stop with duplex tow sealing system. Special insulating inserts completely laid in and glued. Safety bolts screwed in door leaf fold.
Sill:	Threshold profile barrier-free hump sill. Surface galvanized welded to the frame. Threshold profile as barrier-free hump sill surface galvanized welded to the frame. With ground sleeve for the bottom dead bolt.
Frame:	Threesided circumferential folded corner frame with high-quality multi-chamber sealing profile adjustable fixed in the three sided groove. Upper continuous folded weather protection sheet.
Hinges:	Threepart height-adjustable construction hinges with hinge pin retention and ball-bearing spacer ring for smooth door movement.
Fitting:	Worm tension lock in a solid design with robust lock worm, shock mounted striker plate and automatic false control barrier (FB-barrier). Lock prepared for installation of a profile cylinder supplied by customer. Clamping lever in aluminium F1 enforced design ergonomic design, fixed rotatable on with square plate visible screwed to the door leaf. Inactive leaf with attached bolt and lateral swiveling loop handle. Dead bolt made of flat bar steel. For relief of the inactive leaf double paired ball-

bearing track roller in C-rail. Opening angle 90° (optionally 180°).
With double paired ball-bearing track roller in C-rail. Opening angle 90° (optionally 180°).

Surface: Door leaf and frame galvanized and primed with one component primer similar RAL 7001.

Mounting: Delivery and professional assembly including filling of the cavities in the frame with mortar of group III.

Special Models

Standard Glazing: Duplex glazing held by profiled and visibly screwed steel glazing bars. Minimum frieze width 125 mm side and top, base 340 mm.

Pedestrian door: Double walled, level 95 mm thick steel door leaf, four sided folded with thick rebate and adjustable fixed sealing profile in fold. With bottom stop
Special insulating inserts completely laid in and glued.
Worm tension lock in a solid design with robust lock worm, shock mounted striker plate and automatic false control barrier (FB-barrier).
Lock prepared for installation of a profile cylinder supplied by customer .
Clamping lever in aluminium F1 enforced design ergonomic design, fixed rotatable on with square plate visible screwed to the door leaf.

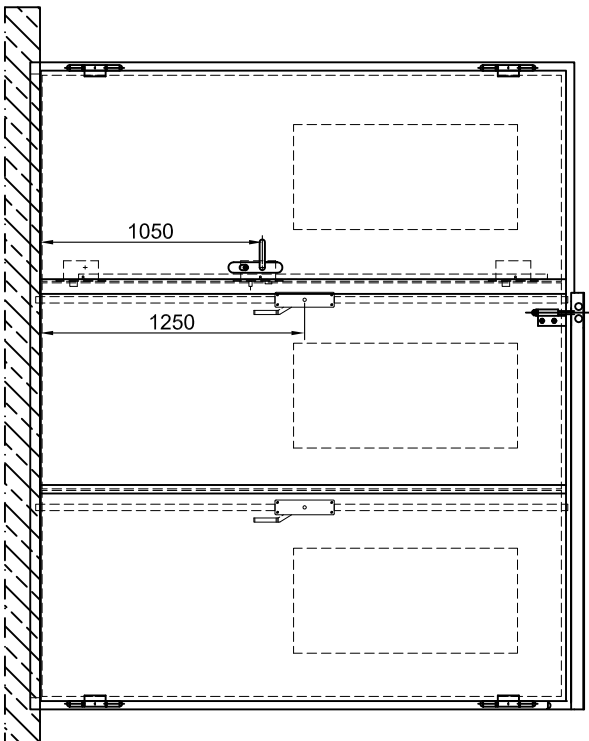
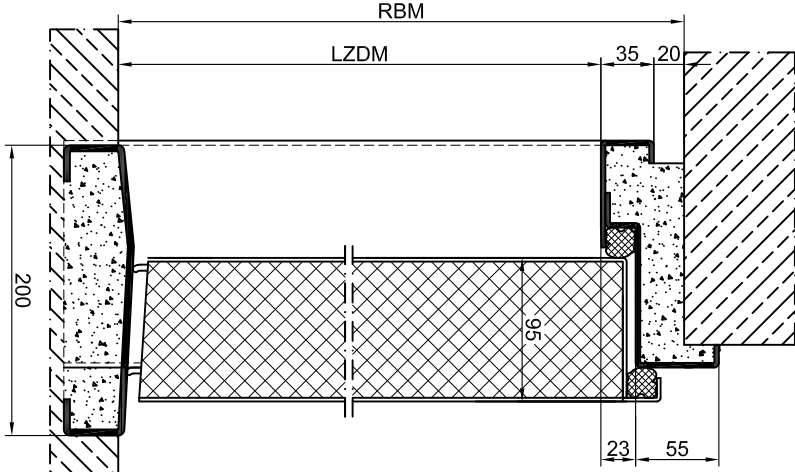
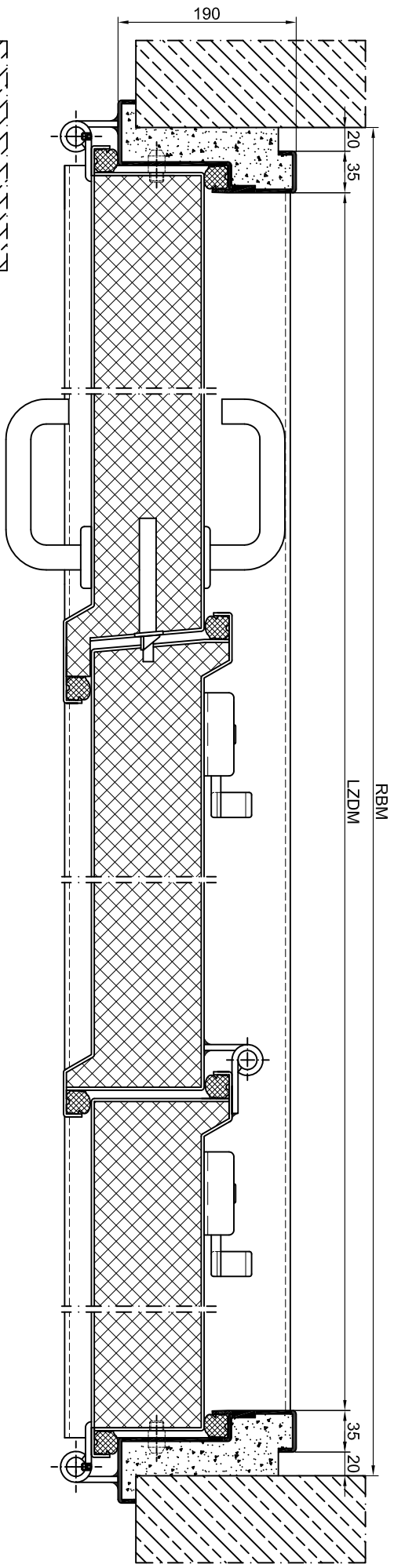

Wing partition

